

PASCAS FOUNDATION (AUST)



PASCAS FOUNDATION (AUST) Ltd
11 Crenshaw Court
Parkwood 4214 Queensland Australia

ABN 23 133 271 593
www.pascasworldcare.com

Bs +61 7 5594 0479
www.pascashealth.com
Em: info@financefacilities.com

8 December 2023

HOMELESS HELPING HAND

INTRODUCTION

Due to some amount of magic and divine intervention we may be able to assist a little those in need and those in need will be helping us in our mutual experiences that we may then embrace, thus we all learn and grow together.

Those who need assistance with secure lodgings are to be supported. The diversity of what unfolds leading to requiring individuals and families to need a helping hand is endless. Domestic violence, homelessness, disabilities, just finding oneself in a foreign environment or country can result in a desperate situation; and that can be for an individual, a parent with child or children, a couple with child or children, they all require whatever is needed for as long as appropriate. Every situation is unique, there is no definition as to how one's life is to unfold, we all have a journey along a pathway of learning and may we be blessed in joining hands and share the wonders of compassion and love to learn and bring about a foundation for growth and prosperity for those we connect with.

Yes, we will prioritise for those considered at greatest risk and extreme stress. That will always be our prerogative.



Helping Hands

Generally speaking:

Consider an Australian wide agenda of providing 100 social housing premises for every 300,000 people around Australia. By the time this program is completed, the population of Australia may well exceed 30,000,000. That is 100 projects with an average of 100 homes delivering 10,000 dwellings with the appropriate support facilities, this may equate to AU\$700,000 per dwelling but anticipate with all the support facilities then AU\$900,000 per dwelling making for a program of AU\$9 billion.

Some projects may be rather small, whereas a few may consist of more than 1,000 dwellings in a single project. Diversity and complexity will reach all limits. Remote regions will be provided with long term support that will be unique to their locations. The growing cities may be provided with large complex possibilities.





Juveniles may be provided with rural settings and these may be within focused villages with an intended population of 1,000 including women, men and their children to reside therein. At other locations, a village setting could be within a growing city.

Throughout every society we have an enormous diversity of needs and disabilities to be provided for.

It is the ongoing support for those who are assisted within these diverse social facilities agendas that is equal to, if not greater, than the accommodation being provided.

It is the capacity to provide ongoing guidance and assistance, addressing issues, as they are revealed, for those being supported, that being what brings about the potential for non-reoccurrence of the crisis.

Kindly consider going to www.pascashealth.com then Library Download page and then Pascas Care Letters section, and click on to open:

-  [Pascas Care Letters Family Shelters Abuse & Remedial.pdf](#)
-  [Pascas Care Letters Family Shelters Overview.pdf](#)
-  [Pascas Care Letters Family Shelters Per Capita Inequality.pdf](#)
-  [Pascas Care Letters Family Shelters Protection.pdf](#)
-  [Pascas Care Letters Family Shelters Social Housing.pdf](#)
-  [Pascas Care Letters Family Shelters Support Centre.pdf](#)
-  [Pascas Care Letters Family Shelters towards Liberation.pdf](#)
-  [Pascas Care Letters Homeless Australia.pdf](#)
-  [Pascas Care Letters Homeless Overview.pdf](#)
-  [Pascas Care Letters Homeless Helping Hand.pdf](#)
-  [Pascas Care Letters Homeless Helping Hand introduction.pdf](#)

SMITH COLLECTIVE, Southport, Gold Coast, Queensland, as a starting point:

A design concept with useable, liveable balconies with tinted glass for privacy, marginally higher balcony balustrades for safety, family living and security all:

Per 100 units:	1 bedroom	30%
	2 bedrooms	30%
	3 bedrooms	30%
	4 bedrooms	10%



Liveable, useable, private with tinted glass and safer with higher balustrades balconies:



GOLD COAST, Queensland, Australia:

Historic and projected population density by statistical area 2 (SA2), City of Gold Coast 2013 & 2036

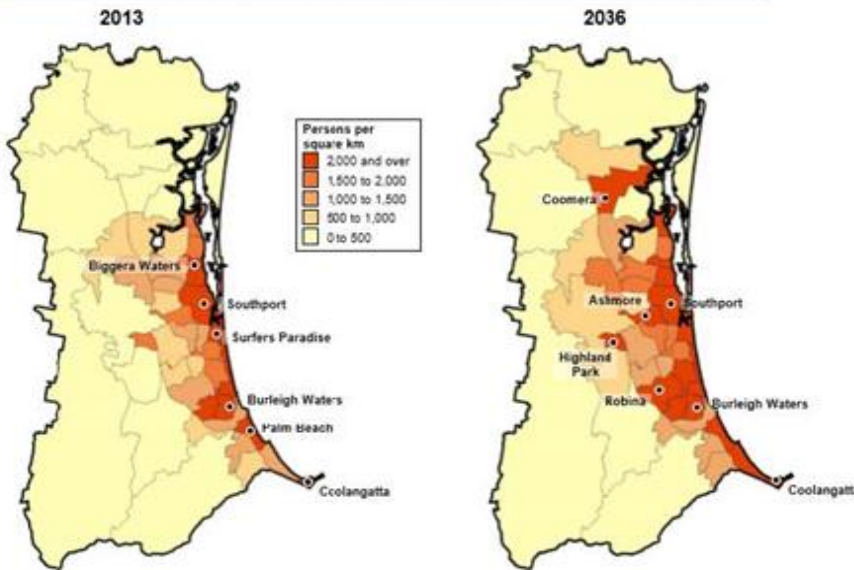

Absolute population growth by SA2, City of Gold Coast 2013-36

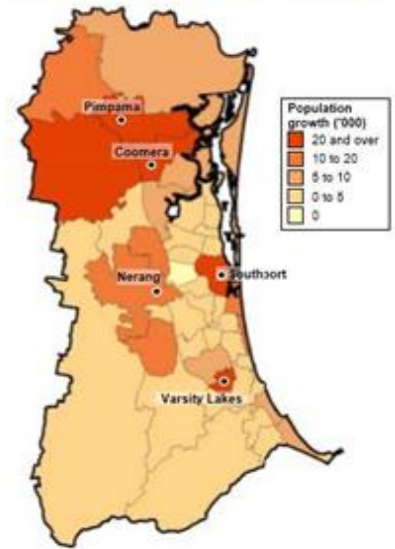

Gold Coast – Tweed Heads metro area population is about 732,000 as of 2023.

Presently, a cluster of 100 units having a combination of 1 bedroom, 2 bedroom, 3 bedroom and larger options (housing for 300) is a priority on the Gold Coast in at least three locations. This is emergency shortage relief.

Brisbane City population is about 2,500,000. Priority is for eight locations to be provided with 100 units each.

Queensland overall population is more than 5,500,000. Fourteen locations need to be established, each with 100 units.

A base need is one such complex for every 300,000 to 330,000 population, thus seventeen Shelter Housing projections would commence to mitigate the pressing need for emergency shelter for domestic violence and homelessness throughout Queensland.

Australia’s population is approaching 27 million, that suggests 90 facilities (9,000 units) throughout Australia is now required and then a shortfall will still need addressing. At an average of 3 persons per unit, that equates to provision for 27,000

persons and the known shortfall is being estimated at 520,000.

Research by the Australian Housing and Urban Research Institute shows Australia is short 173,000 affordable dwellings for rent (consider 3 persons per dwelling) to house 520,000, with Sydney short 60,000 dwellings.

Social housing across Queensland, there are:

**more than 21,000 one-bedroom properties,
about 18,000 two-bedroom homes,
more than 25,000 three-bedroom homes,
6,000 four-bedroom homes and 1,000 larger homes.**

Consider 1 resident per each one-bedroom unit	30 units	30 residents – single adult
Consider 3 residents per each two-bedroom unit	30 units	90 residents – single adult
Consider 4 residents per each three-bedroom unit	30 units	120 residents – single adult
Consider 6 residents per larger units	<u>10</u> units	<u>60</u> residents
Total	100 units	300 residents

Thus 100 adults
with 60 children aged 0 to 6 years
60 children aged 7 to 12 years
50 children aged 13 to 16 years
and 30 mature aged dependants.
300 residents

A Chaldi Chappy is a Pascas Community Counsellor, holding a Social Worker certificate level IV with PfD in the field of Social Work – Living Feelings First.

This is what are the qualifications of a Pascas Counsellor who is also referred to as a Chaldi Chappy having received training through a Chaldi College as an alternative to Pascas University.





Counsellor
Cert IV PFD



Women's Shelter
for 10 women or
6 mums with 10 children



Social Worker certificate level IV with PFD in field of Social Work – Living Feelings First



The Australian wide Need

The current construction rate of social housing – is a little more than 3,000 dwellings a year!

Simply preventing the existing problem from getting worse calls for nearly 15,000 extra dwellings a year to be built. That’s a little over 290,000 homes over the next 20 years.

To eliminate the backlog as well would require an annual program averaging 36,500 units. This would need to begin gradually to build capacity and avoid inflating costs.

The 2016 census counted 116,000 homeless people across Australia. Recognising that some would choose not to live alone, we estimate that our homeless population implies **a need for about 47,000 extra dwellings now.**

Second, our analysis considers the group whose housing needs are not being met by the market. These households are on very low incomes (excluding student households), in private rental housing, and in rental stress – where rent is more than 30% of their earnings. If you are on a very low income, housing costs of this order mean going without other essentials.

Collectively, these components imply a current backlog of 433,000 social housing dwellings.

Table 2: Estimated construction cost, and dwelling type distribution (2017 prices)

Section of Australia	Share of needed growth	Range of estimated cost/unit	Distribution of unit type			
			detached	attached	low-rise	high-rise
Greater Sydney	19.3%	\$210k–\$614k	0%	21%	60%	19%
Rest of NSW	9.9%	\$173k–\$393k	79%	21%	0%	0%
Greater Melbourne	17.5%	\$220k–\$442k	0%	70%	13%	17%
Rest of VIC	5.3%	\$170k–\$203k	100%	0%	0%	0%
Greater Brisbane	10.9%	\$208k–\$357k	15%	61%	23%	0%
Rest of QLD	13.2%	\$179k–\$285k	72%	28%	0%	0%
Greater Perth	9.4%	\$184k–\$316k	0%	92%	8%	0%
Rest of WA	2.5%	\$162k–\$265k	100%	0%	0%	0%
Greater Adelaide	5.6%	\$184k–\$261k	0%	83%	17%	0%
Rest of SA	1.3%	\$146k–\$157k	100%	0%	0%	0%
Greater Hobart	0.9%	\$271k	100%	0%	0%	0%
Rest of TAS	1.0%	\$172k–\$189k	100%	0%	0%	0%
ACT	1.2%	\$418k	0%	100%	0%	0%
Greater Darwin	0.4%	\$256k	0%	100%	0%	0%
Rest of NT	1.5%	\$186k	100%	0%	0%	0%
Overall	100.0%	\$146k–\$614k	32%	44%	18%	7%

Source: authors.

Addressing the deficit and future need will call for the construction of some 730,000 new social dwellings over the next 20 years. This equates to an annual average growth of 5.5% over the existing stock. 36,500 new social dwellings are required throughout Australia every year.

Newly emerging need will expand the shortfall to 727,000 dwellings by 2036 being 36,500 homes per annum being required.

Table 4: Comparison of five investment pathways

Program Summary	Scenario 1: Yr1 total	Scenario 2: Yr1 Total	Scenario 3: Yr1 Total	Scenario 4: Yr1 Total	Scenario 5: Yr1 Total
Total development costs (excl. GST and taxes)	\$7.0 billion	\$6.4 billion	\$5.8 billion	\$5.7 billion	\$5.4 billion
Total operating costs	\$2.8 billion	\$2.8 billion	\$2.8 billion	\$2.8 billion	\$2.8 billion
Rental income	\$3.2 billion	\$3.2 billion	\$3.2 billion	\$3.2 billion	\$3.2 billion
Operating Subsidy/Capital Grant	\$5.4 billion	\$4.8 billion	\$4.2 billion	\$4.1 billion	\$5.0 billion
CRA Payments	\$1.2 billion	\$1.2 billion	\$1.2 billion	\$1.2 billion	
Government subsidy	\$6.6 billion	\$6.0 billion	\$5.4 billion	\$5.3 billion	\$5.0 billion
Savings on Yr1 scenario	—	9%	18%	20%	24%

Source: authors.

Now to address the Root Cause!

Provision of Family Shelter accommodation is to be considered in modules of 10 and then of larger modules of 100. This is to bring about practical support arrangements. Support counsellors are more appropriately engaged in supporting ten women or six mothers with ten children.

When providing educating and training facilities, then the diversity of requirements tend to generate practical utilisation when supporting 100 accommodation units. **Such accommodation units maybe 1, 2, 3 or more beds. Consider a configuration of 30 x 1 bedrooms, 30 x 2 bedrooms, 30 x 3 bedrooms and then 10 units with 4 or even more bedrooms. Essentially the population per unit is not to exceed six persons all being of the one family.**

Considering a Family Shelter of 100 units with an overall population of 300, we may anticipate that 100 adults would be with 200 children including mature aged dependants and that the children would range in age from 0 to 16 and the mature age dependents would be of any age.

A 100 unit Family Shelter population:

Thus 100 adults

with 60 children aged 0 to 6 years

60 children aged 7 to 12 years

50 children aged 13 to 16 years

and 30 mature aged dependants.

300 residents **(3 per unit average)**

One counsellor is best engaged with 10 adults or with six mothers and their 10 children when assisting those escaping domestic violence. As a Family Shelter may have 100 adults, with between 60% to 75% escaping domestic violence, then around 15 counsellors with experiences encapsulating the skills called upon may be appropriate for such a community. These being counsellors with Social Worker certificate level IV + Pfd in the field of SOCIAL WORK – LIVING FEELINGS FIRST.

- **A frontline facility may be a Pascas Café with showers, laundering, business centre and meetup area.**
- **A small Pascas Family Shelter would have 1 counsellor to assist 10 adults or 6 mothers with 10 children.**
- **A medium Pascas Family Shelter may have 30 units to house 90 residents with meeting rooms, community play areas and have 5 or 6 counsellors.**
- **A full Pascas Family Shelter may have 100 units to house 300 residents with Pascas Crèche, Pascas Café, community meeting area and business facilities and have 15 counsellors including administration.**

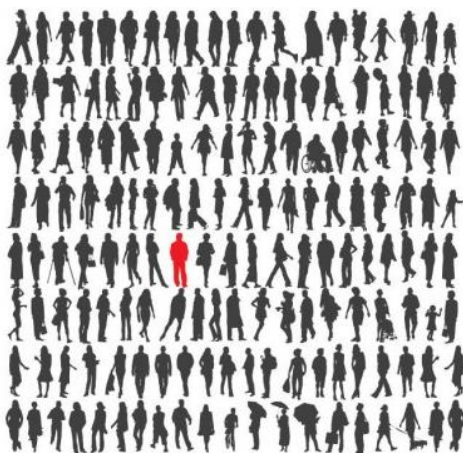

On any given
night in Australia
1 in 200 people
are homeless

Common Ground



Common Ground proposed projects:

Southport	200 units	AU\$120 million	2 year build
Cairns	60 units	\$40 million	
Fortitude Valley	200 units	\$180 million	
Tweed Heads	100 units	\$60 million	
Recurrent ongoing costs		\$100 million	

Program initial		AU\$500 million	

Scarborough St, Southport:



200 Units

1 bed units for single or couples – living area with space for short term visitors

Studio units – designed with some separation / differentiation between sleeping area and living space

Self contained with kitchen, bathroom and laundry

Disability access and wheelchair access

Sound attenuation between units

Cross ventilation – bathroom ventilation

Special considerations:

For some units on lower levels close to support staff for highly complex tenants.

Additional sound attenuation – area to accommodate "pacing"

Proximity to sensory modulation room

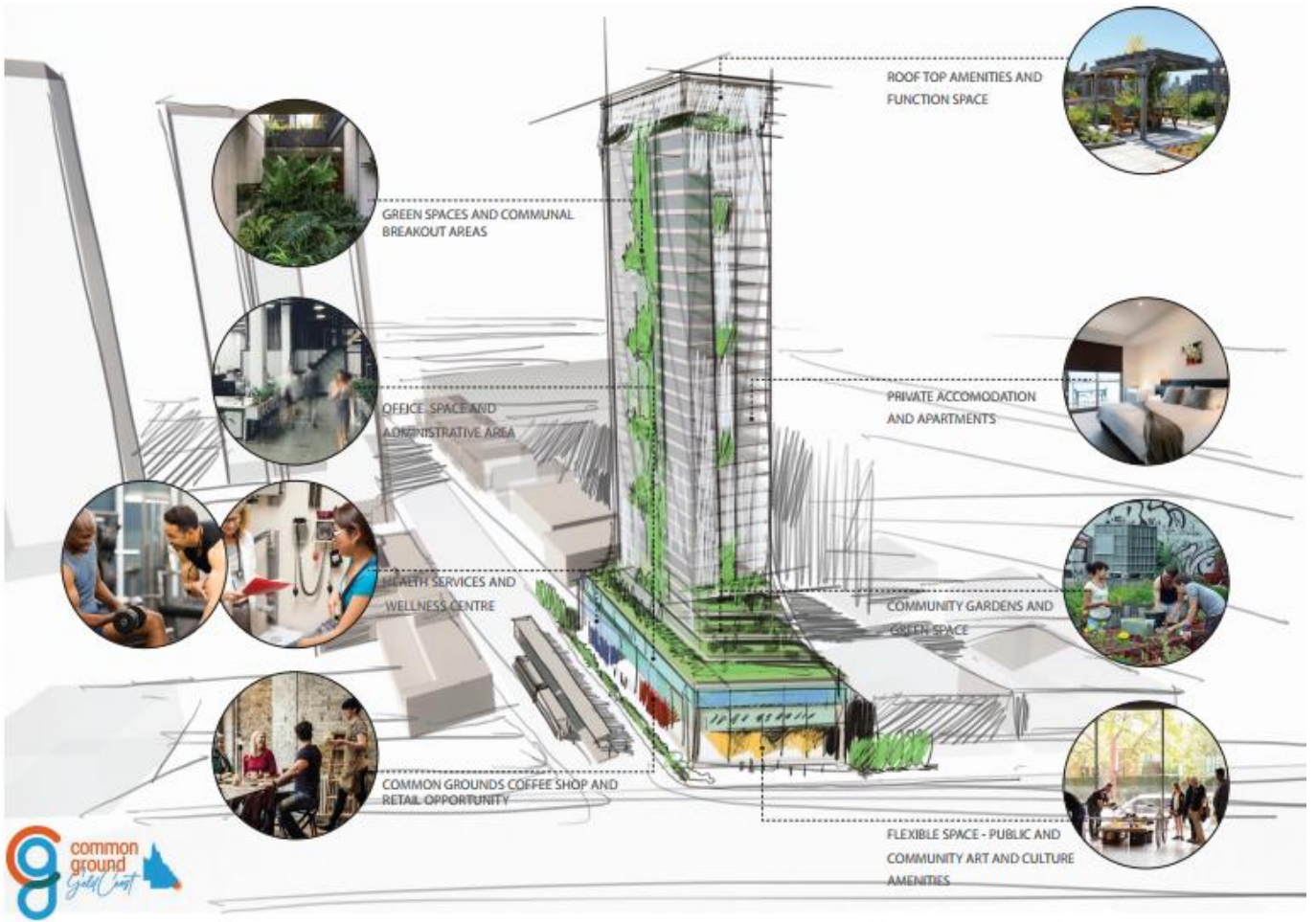

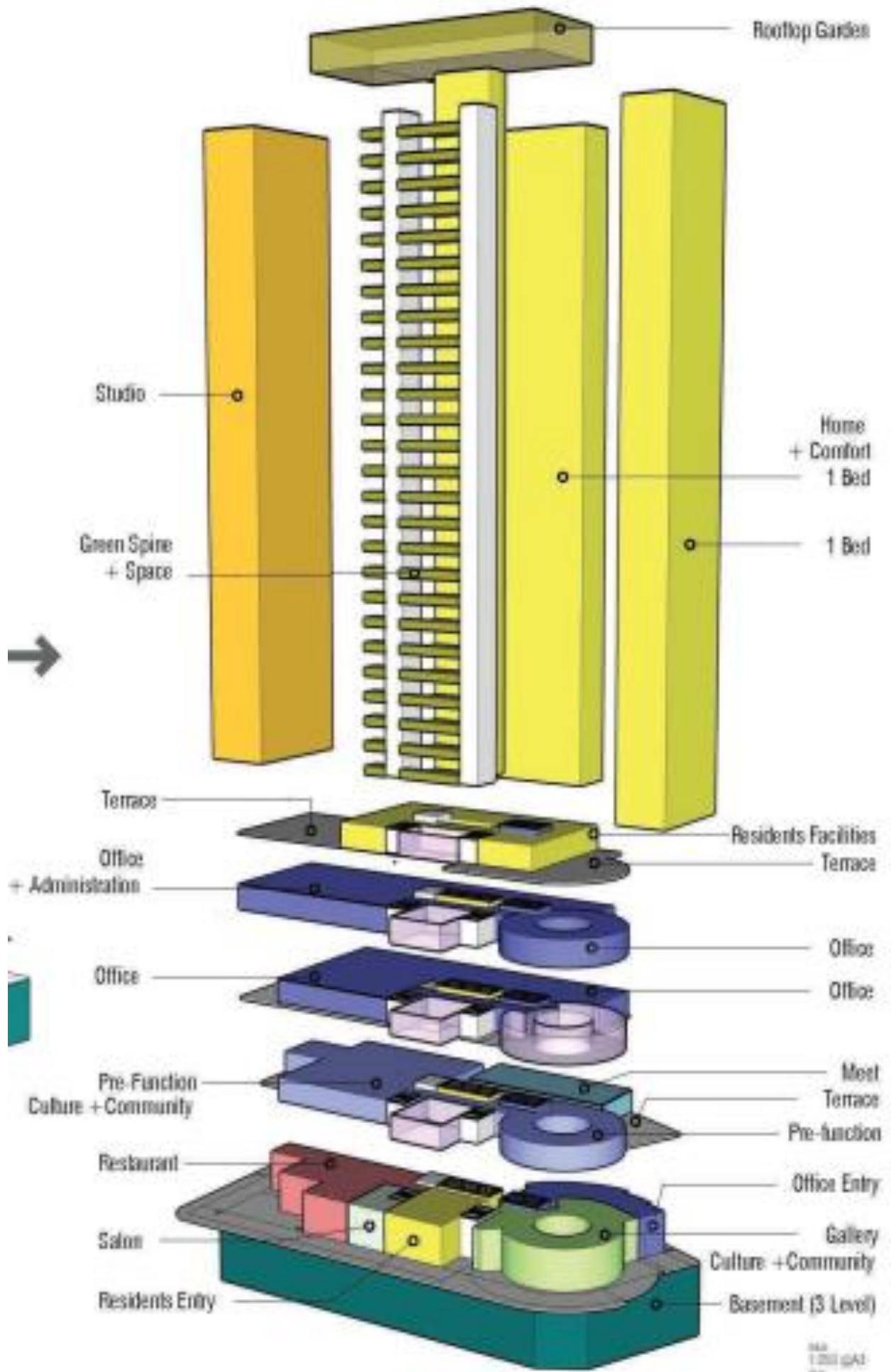

A NATION'S or COMMUNITY'S COLLECTIVE SOUL CONDITION:

Correlation of Levels of Consciousness – Soul Condition – and Society Problems				
Level of Consciousness	Rate of Unemployment	Rate of Poverty	Happiness Rate “Life is OK”	Rate of Criminality
600 +	0%	0.0%	100%	0.0%
500 - 600	0%	0.0%	98%	0.5%
400 - 500	2%	0.5%	79%	2.0%
300 - 400	7%	1.0%	70%	5.0%
200 - 300	8%	1.5%	60%	9.0%
100 - 200	50%	22.0%	15%	50.0%
50 - 100	75%	40.0%	2%	91.0%
< 50	95%	65.0%	0%	98.0%

One's soul condition has a direct relationship with all facets of living. To grow and improve one's soul condition is the greatest gift one can give him or herself as it has universal benefits that last for eternity. This is achieved by embracing Feeling Healing through which we commence to repair the damage incurred by the Rebellion and Default that is passed down to us by our parents. Further, by embracing Divine Love with Feeling Healing we are doing our Soul Healing and progressing towards Celestial status.

Dr David R Hawkins' development of the Map of Consciousness (MoC) and research with kinesiology muscle testing observed the overall calibration of consciousness level of many countries. Developed economies are within the highest brackets. Civil unrest and wars are most frequent amongst those within the lowest brackets. Consider the average life expectancy and per capita income relative to the MoC calibration. Consider education as the crux of progress and development. Then review the above table for the rate of unemployment, rate of poverty, happiness rate 'life is okay' and rate of criminality.

MoC	No. of Countries	Average MoC	Average Life Expectancy	Human Development Index	Happiness Index	Education Index	Per Capita Income 2020
400s	10	406	78.50	0.939	6.8	.861	US\$54,010
300s	13	331	71.77	0.798	5.9	.684	US\$17,827
200s	10	232	69.45	0.759	5.8	.648	US\$16,972
High 100s	18	176	69.00	0.724	5.2	.639	US\$9,900
Low 100s	7	129	61.88	0.653	4.7	.567	US\$2,628
Below 100	11	66	52.73	0.564	4.2	.488	US\$2,658
WORLD		220	70				US\$10,900

Great Transformation of Humanity!



An interesting stipulation regarding funding clearance for each project:

Professionals in the field of social housing within the community for which the facility is being considered are to provide a written consideration as to what they feel is required in their area.

Those who are considered as 'social workers' in the region of the proposed housing and support project are to sign off an approval on their aspects of interest before design work is completed.

Those who are engaged in supporting the residents of each facility are to sign off an approval for what is to be constructed and also the fitting out before construction may commence.

Where possible, those in need are to be asked to outline what they consider would best assist them in resolving their crisis and stress. A written commentary is always to be provided please.

If we don't ask we will never know. And once we do know, we cannot unknow!

Ladies and gentlemen, this unique situation and opportunity is not only available for Australia, as we gather momentum, then other countries may be provided with similar support for their communities and people of any and all ethnicities.

cheers for now

John Doel for

Pascas Foundation (Aust) Ltd